

PLAN OF SLAB-TOP AND SIDE-WALK  
Scale - 1/4" = 1'-0"

REINFORCED CONCRETE BEAM  
All longitudinal bars - 3/8" dia.  
Bars to be bent up over, and  
6" CEMENT-CONCRETE SLAB TOP  
All longitudinal and transverse bars bent up as  
shown in Section; longitudinal bars spaced as shown.

PROFILE ON CURB LINE  
Scale - 1/2" = 1'-0"

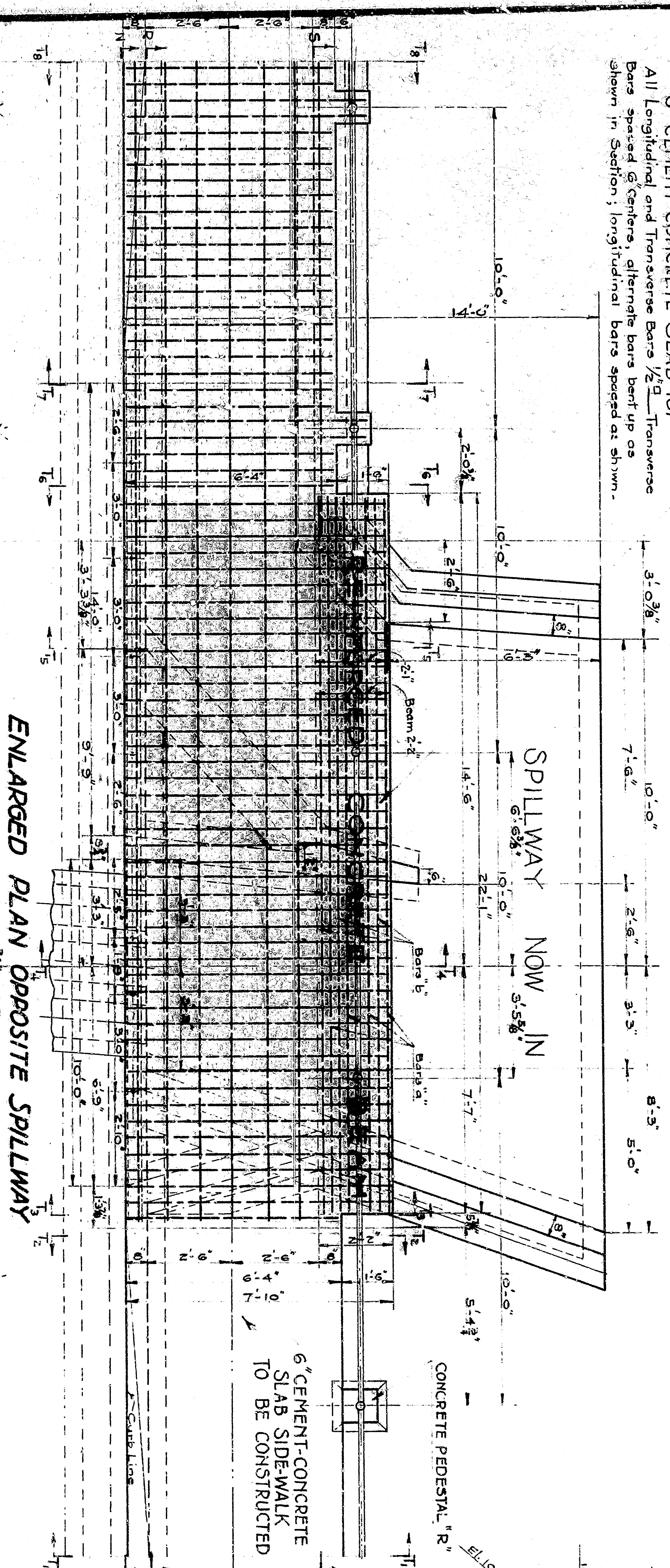

ENLARGED PLAN OPPOSITE SPILLWAY  
Scale - 3/8" = 1'-0"

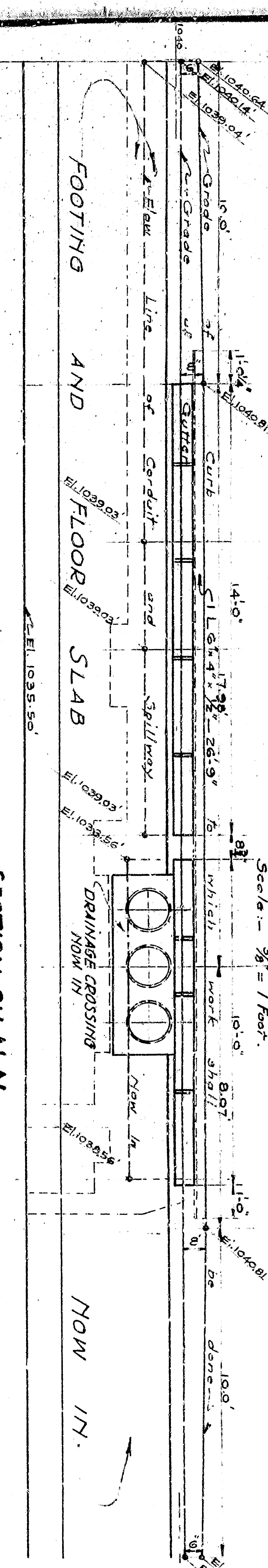

SECTION ON N-N

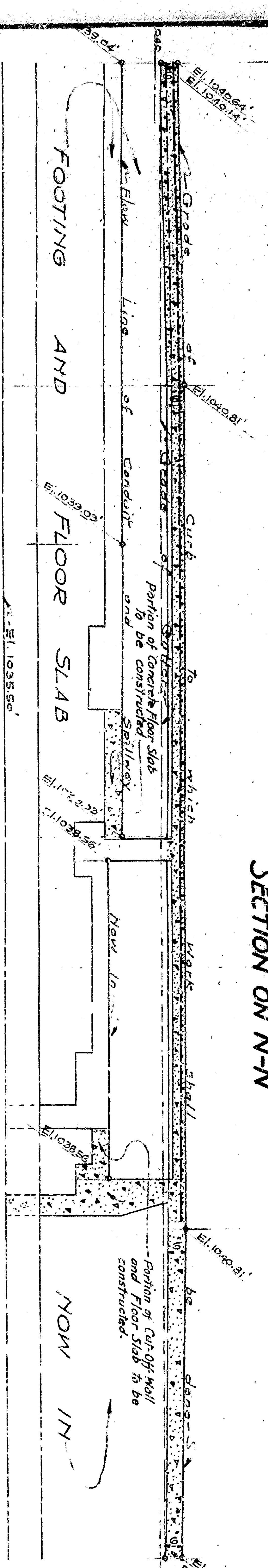

SECTION ON R-R

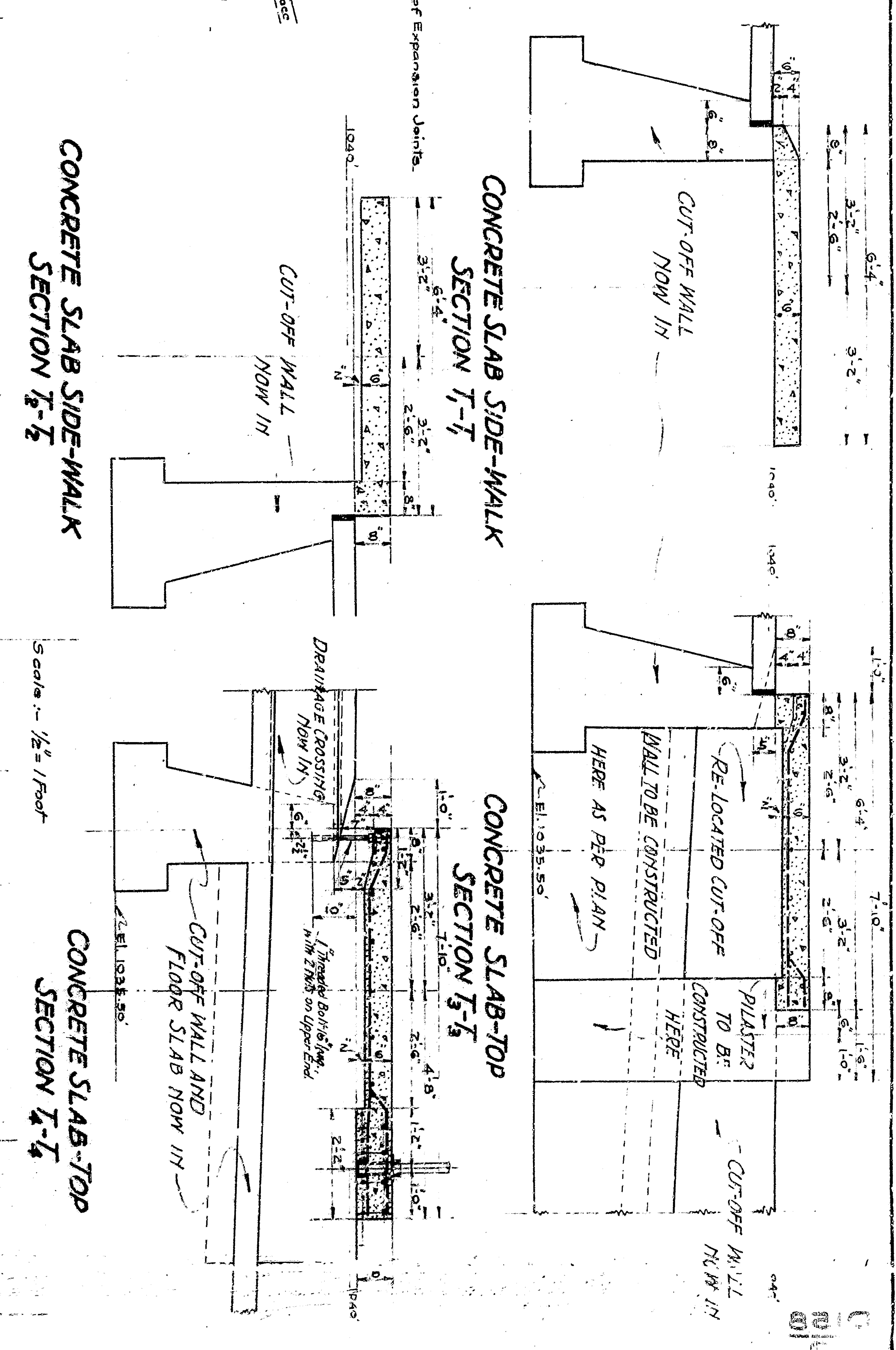

CONCRETE SLAB SIDE-WALK  
SECTION T-T

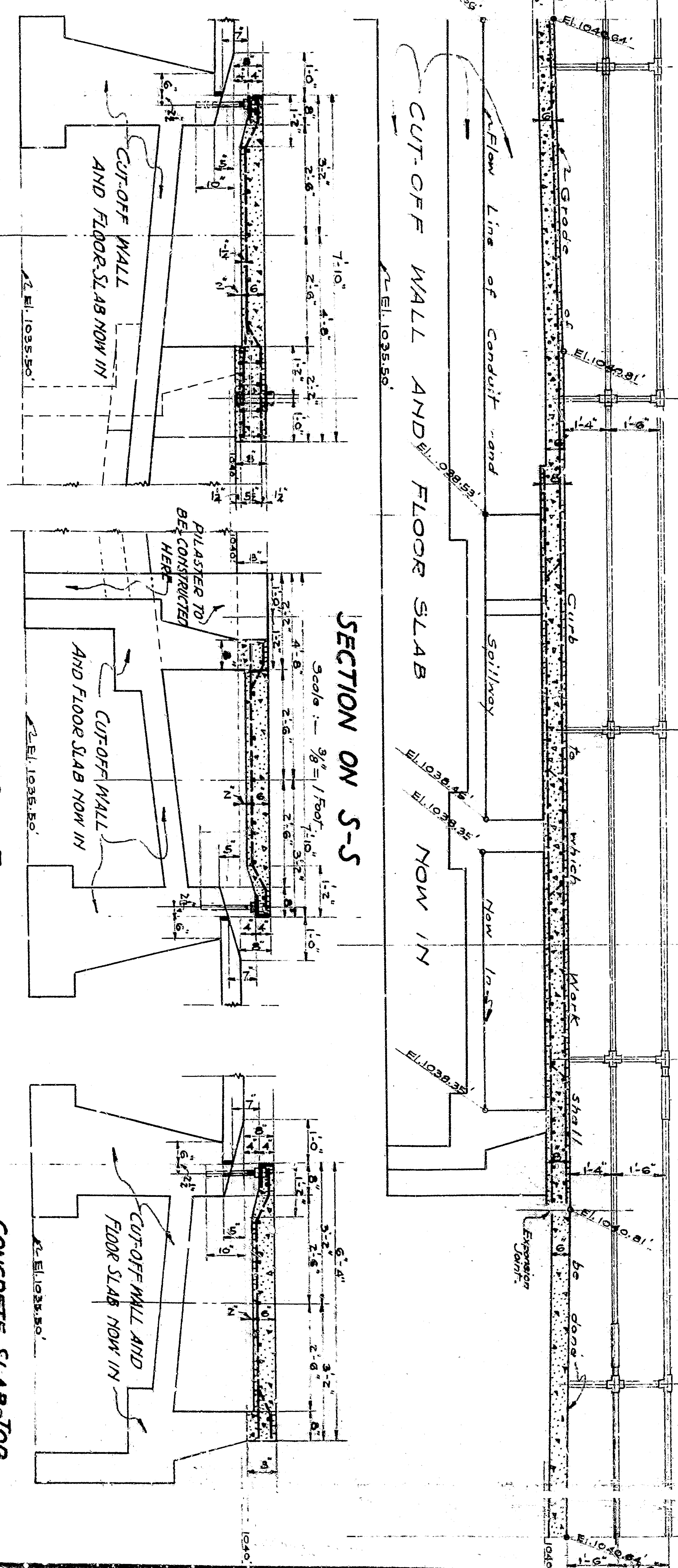

SECTION ON S-S

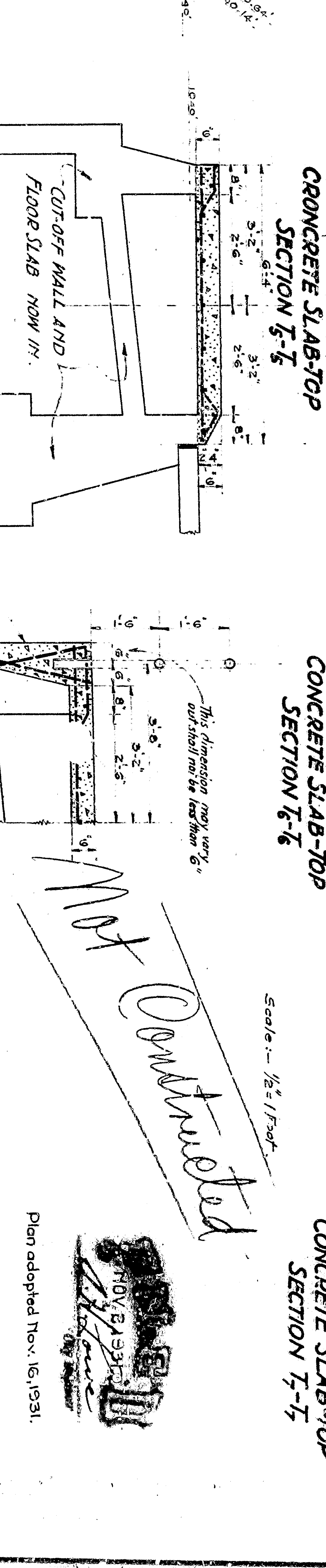

CONCRETE SLAB-TOP  
SECTION I-I

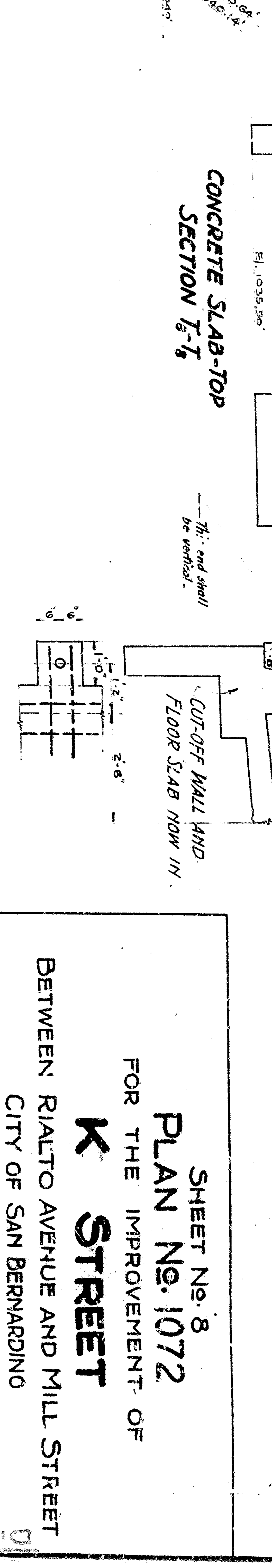

DETAIL SHOWING  
RAILING POST BRACKET B1

*Not Constructed*

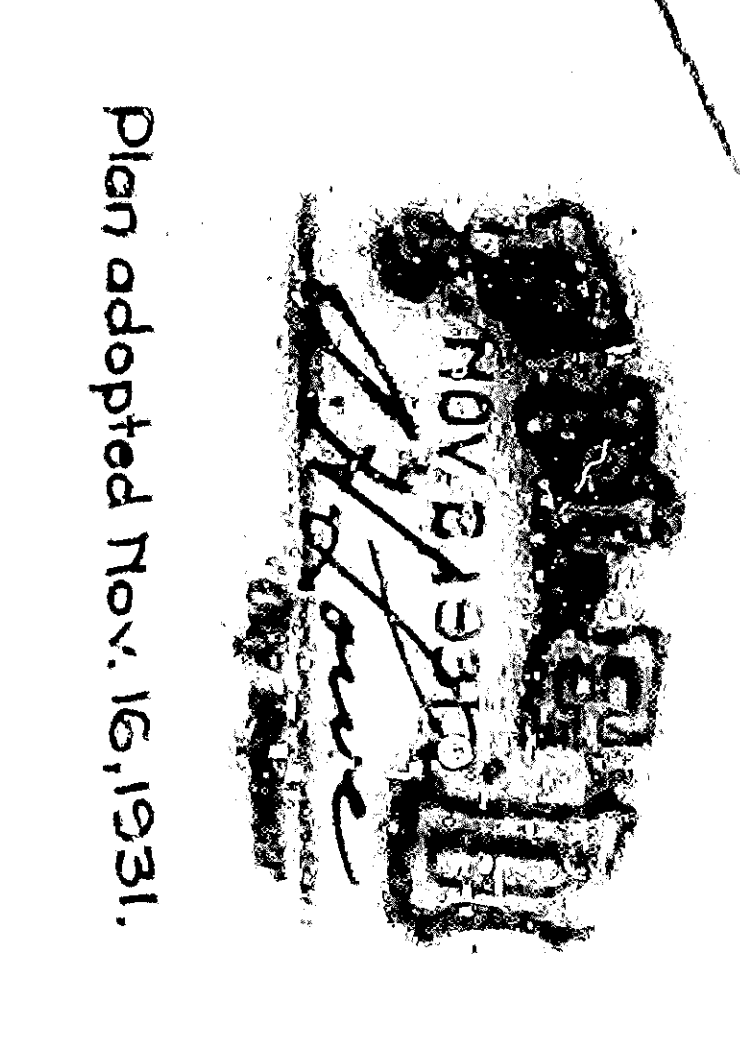

Plan adopted Nov. 16, 1931.

SHEET No. 8  
FOR THE IMPROVEMENT OF  
**K STREET**  
BETWEEN RIALTO AVENUE AND MILL STREET  
CITY OF SAN BERNARDINO  
CALIFORNIA  
A. H. LOWE  
CITY ENGINEER  
SEPTEMBER 1931

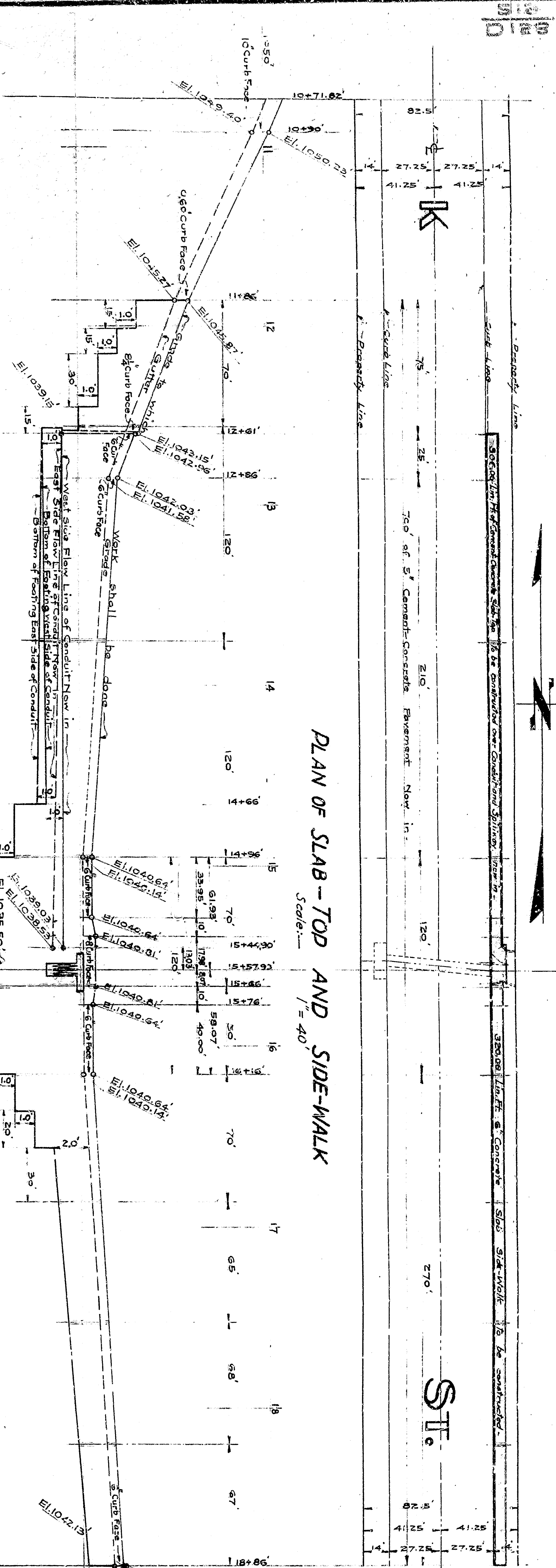

PLAN OF SLAB-TOP AND SIDE-WALK  
Scale - 1/4" = 1'-0"

REINFORCED CONCRETE BEAM  
All longitudinal bars - #6 in. Bars to be in both top and bottom, confining bars to be in both ends bent up over, and one 6" CEMENT-CONCRETE SLAB TOP  
All longitudinal and transverse bars 1/2" diameter Bars longitudinal and transverse bars bent up as shown in Section; longitudinal bars spaced as shown.

PROFILE ON CURB LINE  
Scale - 1/2" = 1'-0"

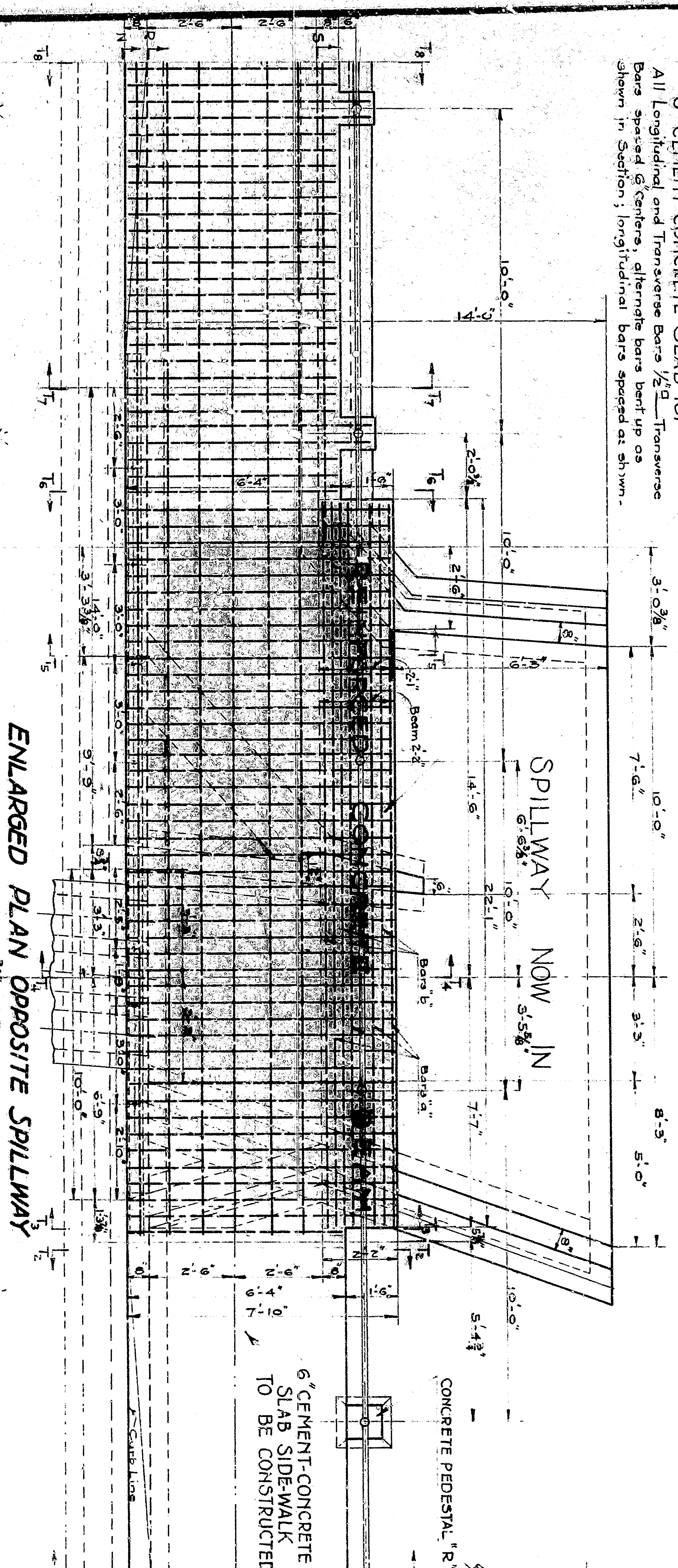

ENLARGED PLAN OPPOSITE SPILLWAY  
Scale - 3/8" = 1'-0"

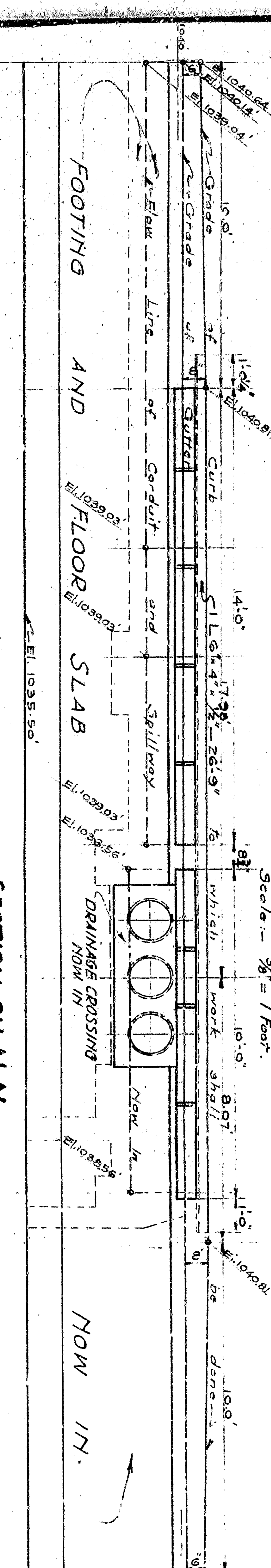

SECTION ON N-N

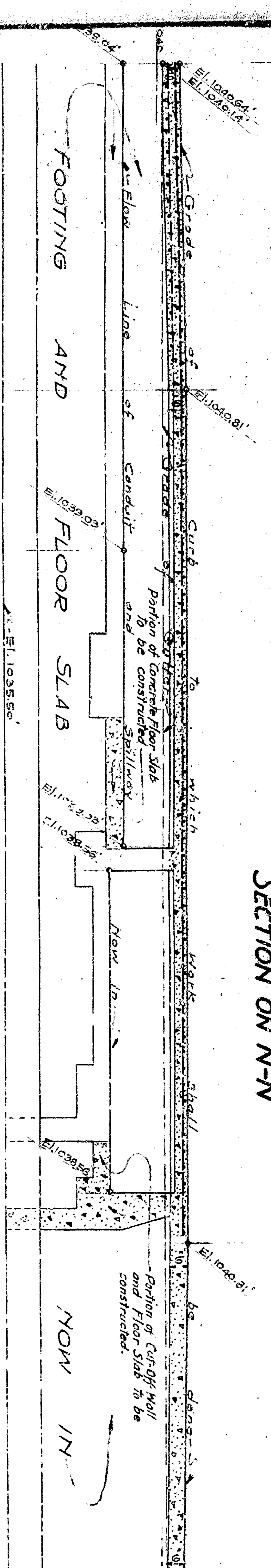

SECTION ON R-R

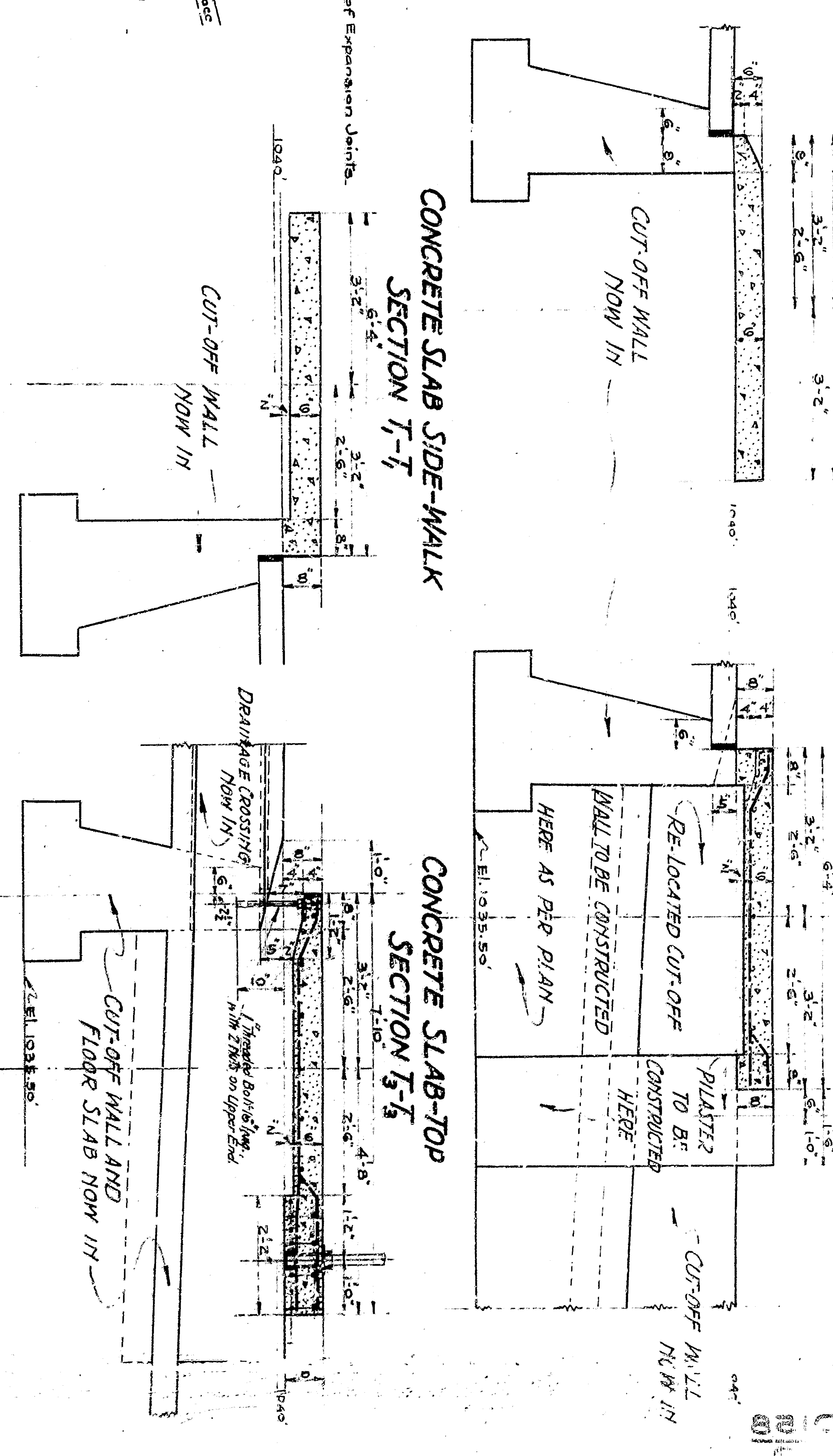

CONCRETE SLAB SIDE-WALK SECTION T-T

CONCRETE SLAB SIDE-WALK SECTION T-T

CONCRETE SLAB-TOP SECTION T-T

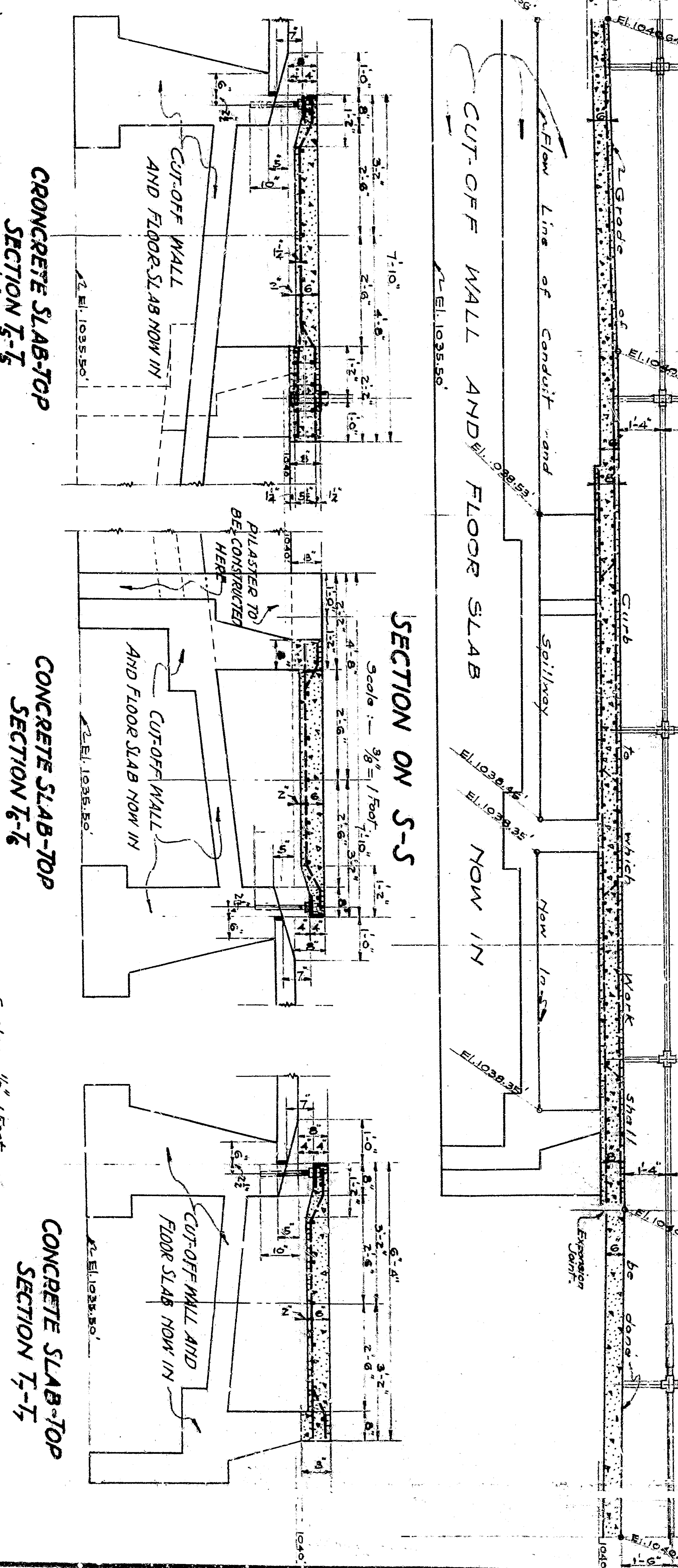

SECTION ON S-S

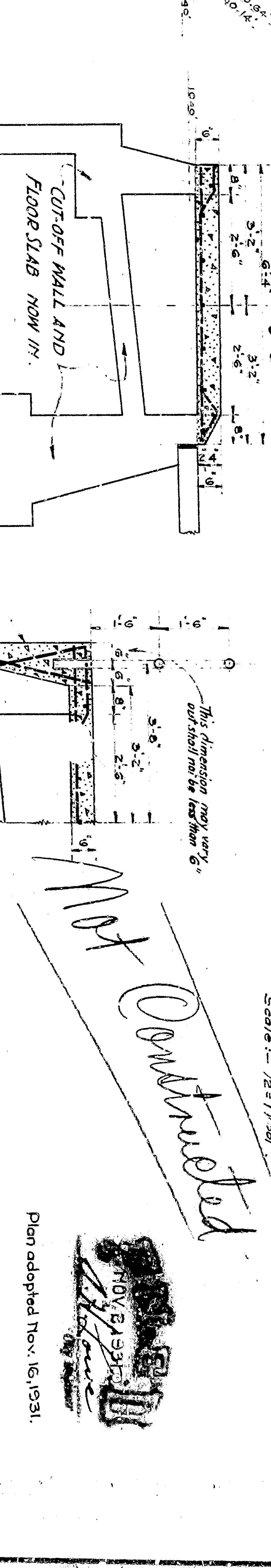

CONCRETE SLAB-TOP SECTION T-T

CONCRETE SLAB-TOP SECTION T-T

CONCRETE SLAB-TOP SECTION T-T

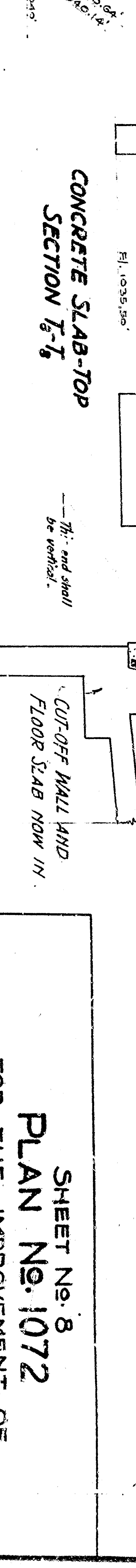

CONCRETE SLAB-TOP SECTION T-T

CONCRETE SLAB-TOP SECTION T-T

CONCRETE SLAB-TOP SECTION T-T

DETAIL SHOWING RAILING POST BRACKET BI

*Not Constructed*

NOV 1933

Plan adopted Nov. 16, 1931.

SHEET No. 8  
FOR THE IMPROVEMENT OF  
**K STREET**  
BETWEEN RIALTO AVENUE AND MILL STREET  
CITY OF SAN BERNARDINO  
CALIFORNIA  
A. H. LOWE  
CITY ENGINEER  
SEPTEMBER 1931